

# BSV-CHR/IR

## Installation Manual



**Product Name:** BSV-CHRYSLER-2016

**Product Application:**

Blind Spot Video for Front Camera, Right Camera, Left Camera, and also Insert Night Vision Camera to OE screen.

**Car Types:** Chrysler/Jeep/Dodge U-Connect 8.4 Systems (2013-2018).

Jeep; Wrangler JL, Renegade, Grand Cherokee, Cherokee, Compass. Chrysler; 200C,300C, Pacifica. Dodge; Ram, Viper, Dart, Challenger, Charger

*\*NOTE: Make sure there is NO CD drive on the dash board. Not suitable for cars with CD drive on Dashboard.*

## What's in the box:

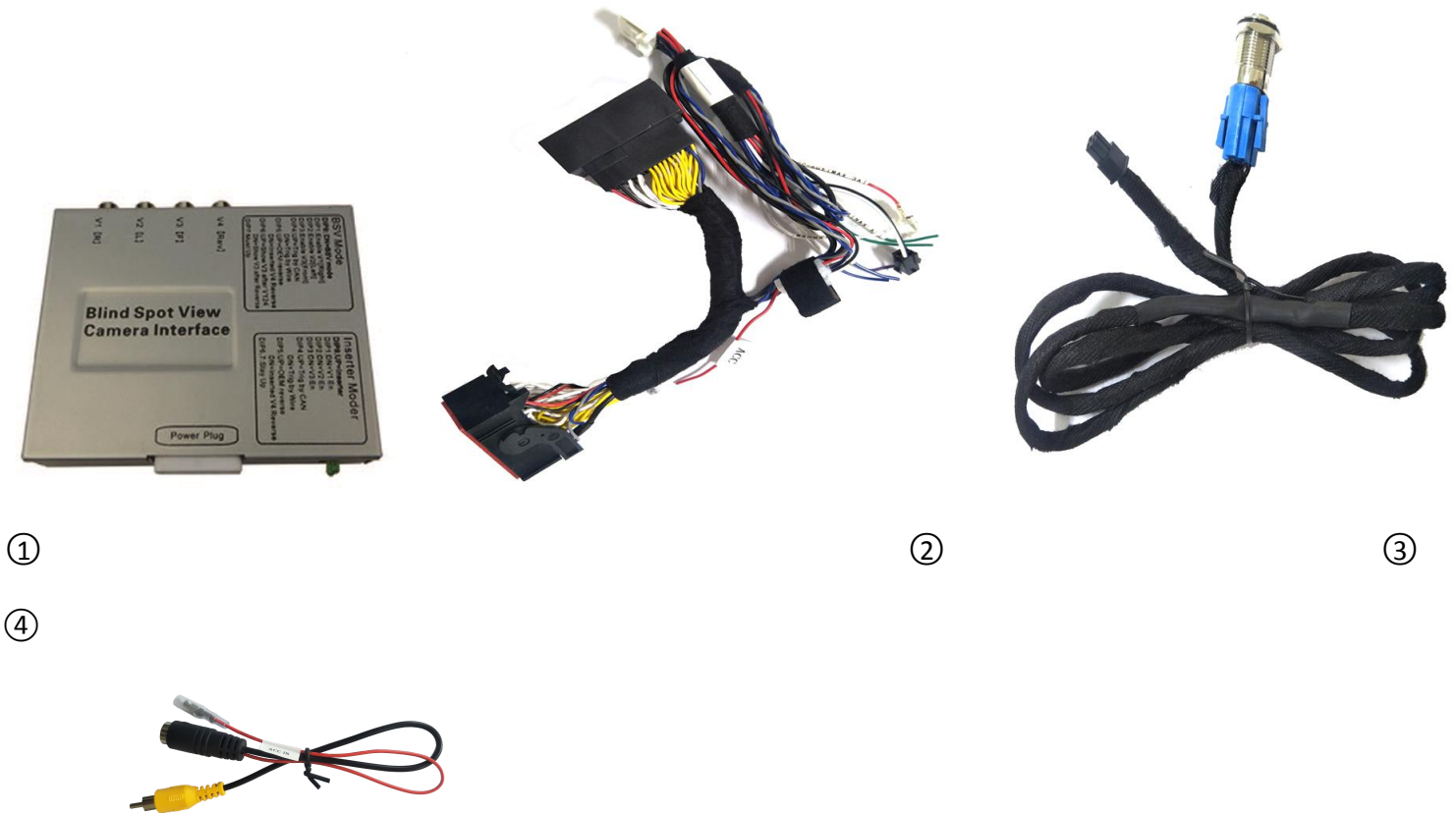

Item	Qty	Description	Part No.
1	1	Interface Box	1
2	1	Power CAN Harness	2
3	1	External Switch	3
4	1	Transfer cable	4

### 1. Description:

- The BSV-CHRYSLER-2016 camera interface is the latest line of product from FOSP, It will enable user to install Front Night Vision Camera, left side camera and right side camera on the OE screen. Cameras can be triggered by turn signals or external button (Press once to enter turn signals, Press again to go to next view and then back to OEM).

*\*NOTE: Please refer to DIP setting for different settings of interface.*

## 2. Installation:

Installation of this interface is very easy as it is completely plug and play. There is no need to open the radio to insert any PCB etc.

- Each car model has a different process to open the dashboard panel. (Please check the Car manufacturers manuals to know how to open the dashboard and access the panels).
- All the installation will be done behind the LCD. This makes installing the interface very simple and easy. Just connect one power CAN harness and set the DIP settings.
- The Power Harness will be removed from behind the LCD and our harness will be installed in place of the harness. The removed cable will be inserted in its place.

## 3 .System connection

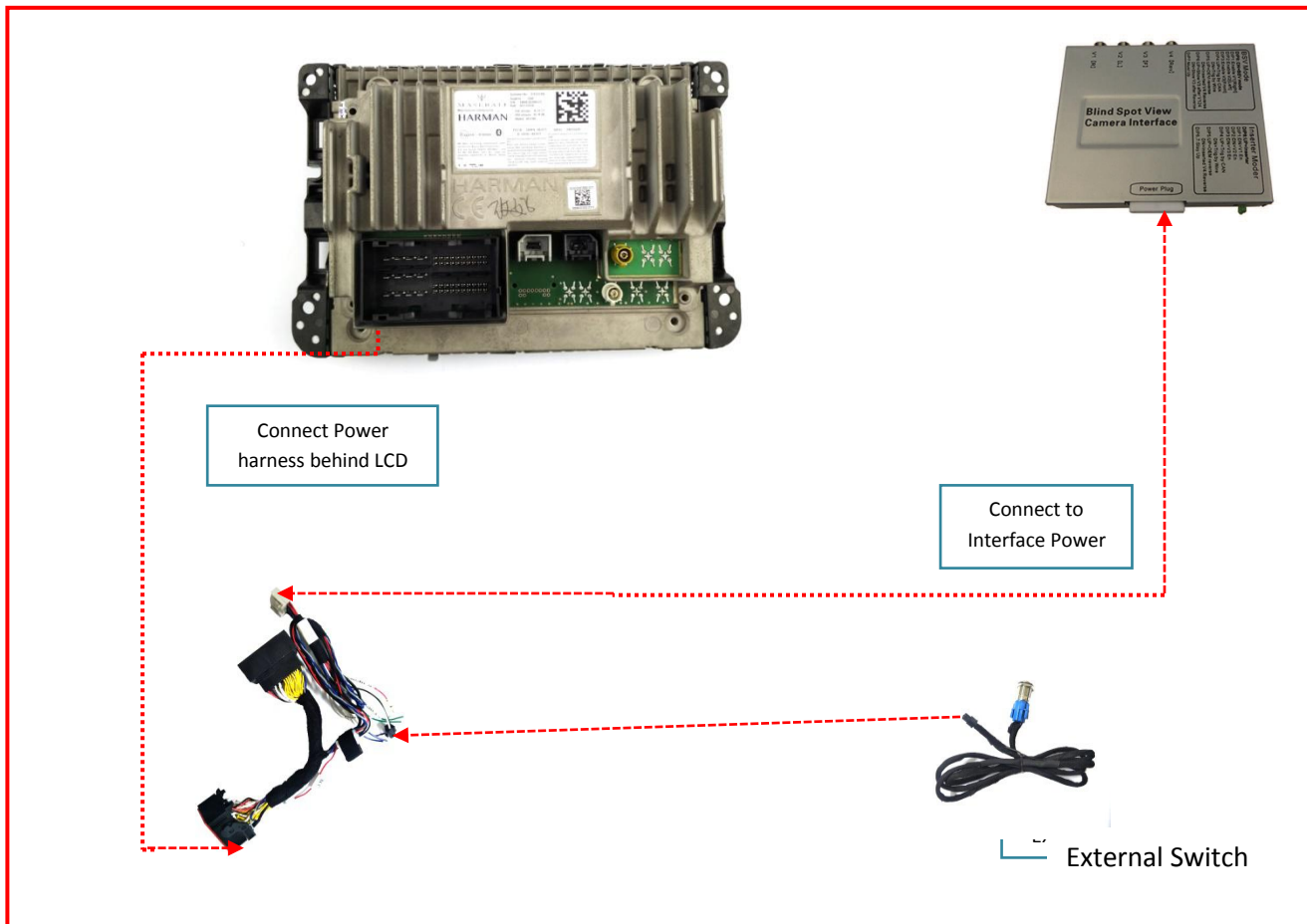

*\*NOTE: Make sure that the power harness has been connected securely if not connected properly there may be problems in power being sent to the interface .*

4. Connection Diagram:

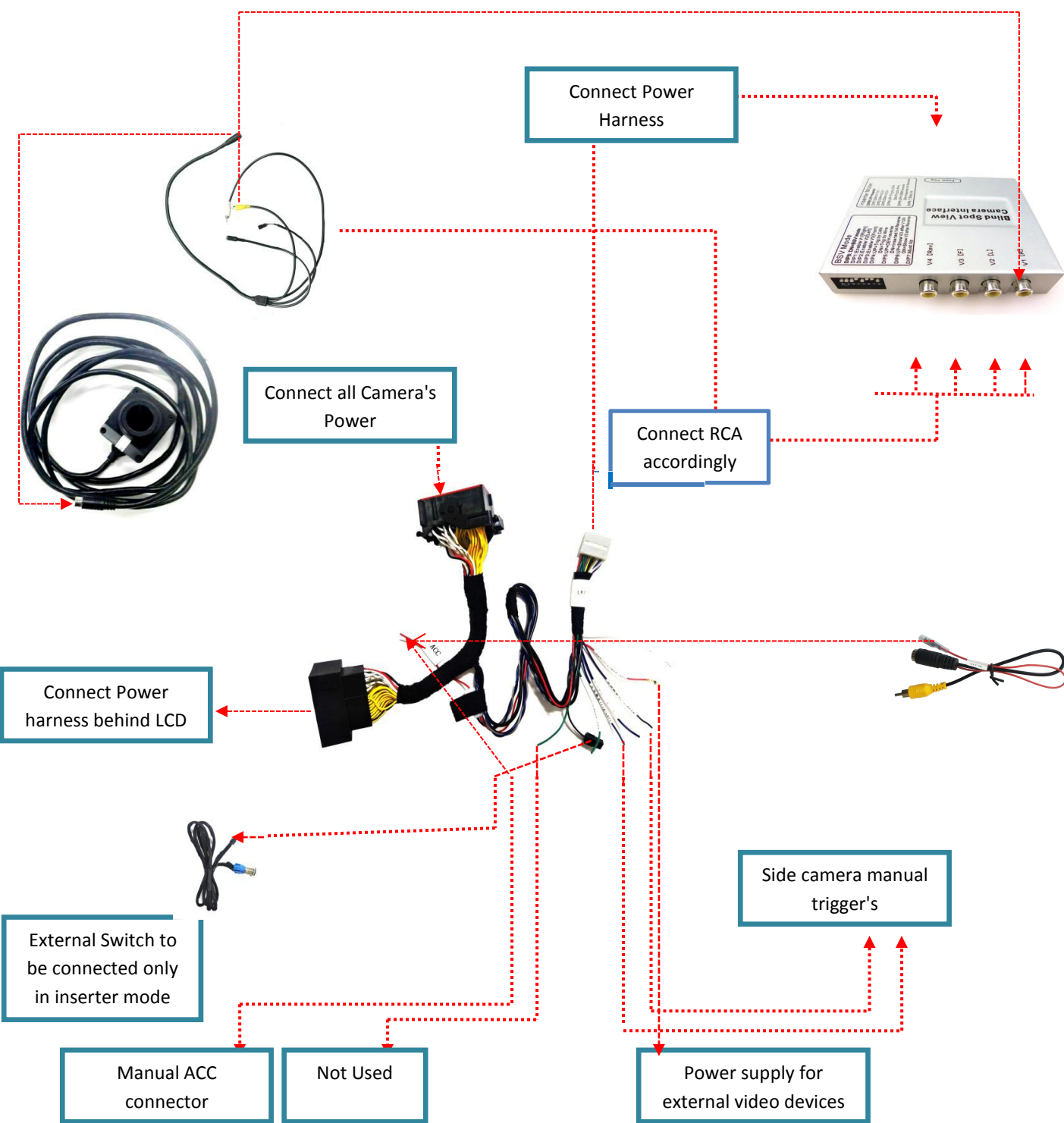

## 5. Interface DIP Settings:

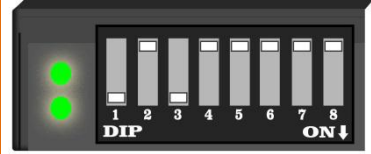
<div> <div>DIP Down= ON      DIP UP= OFF</div>  </div>			
DIP	ON	OFF	Default
1	Enable V1	Disable V1	DOWN(ON)
2	Enable V2	Disable V2	UP (OFF)
3	Enable V3	Disable V3	UP (OFF)
4	Manually Triggered inputs	CAN Triggered inputs	UP(OFF)
5	Reverse camera installed (When R engaged aftermarket camera shown)	OE camera is installed (When R engaged OE camera shown)	UP(OFF)
6	No Function (always Keep OFF)	No Function (always Keep OFF)	UP(OFF)
7	No Function (always Keep OFF)	No Function (always Keep OFF)	UP(OFF)
8	No Function (always Keep OFF)	No Function (always Keep OFF)	UP(OFF)

*\*NOTE: All the camera's can be powered by the green wire[12V, Max 3A]. There will be power to the camera only in the case of triggered state. In not triggered state it will carry 0V.*

## 6. Parameters:

No.	Name	Parameter
1	Front Cam Video , Reverse Cam video	0.7Vpp with 75 ohm impedance  NTSC/PAL/SECAM automatic switch
2	Reverse Control wire	>5V will force into camera mode.  these wires can tolerate 12V for <10 seconds.
3	Normal Power consumption	4.8W
4	Standby current	< 10uA
5	Reverse trigger threshold	>5V trigger
6	Work temperature	-40°C to +85°C
7	Dimensions	11*9*2

*\*\*For more assistance please contact the sales team.\*\**